

EXAMPLE BASIC LIGHTING PLAN

Site Address: 323 Myroad, Tumwater, WA 98501

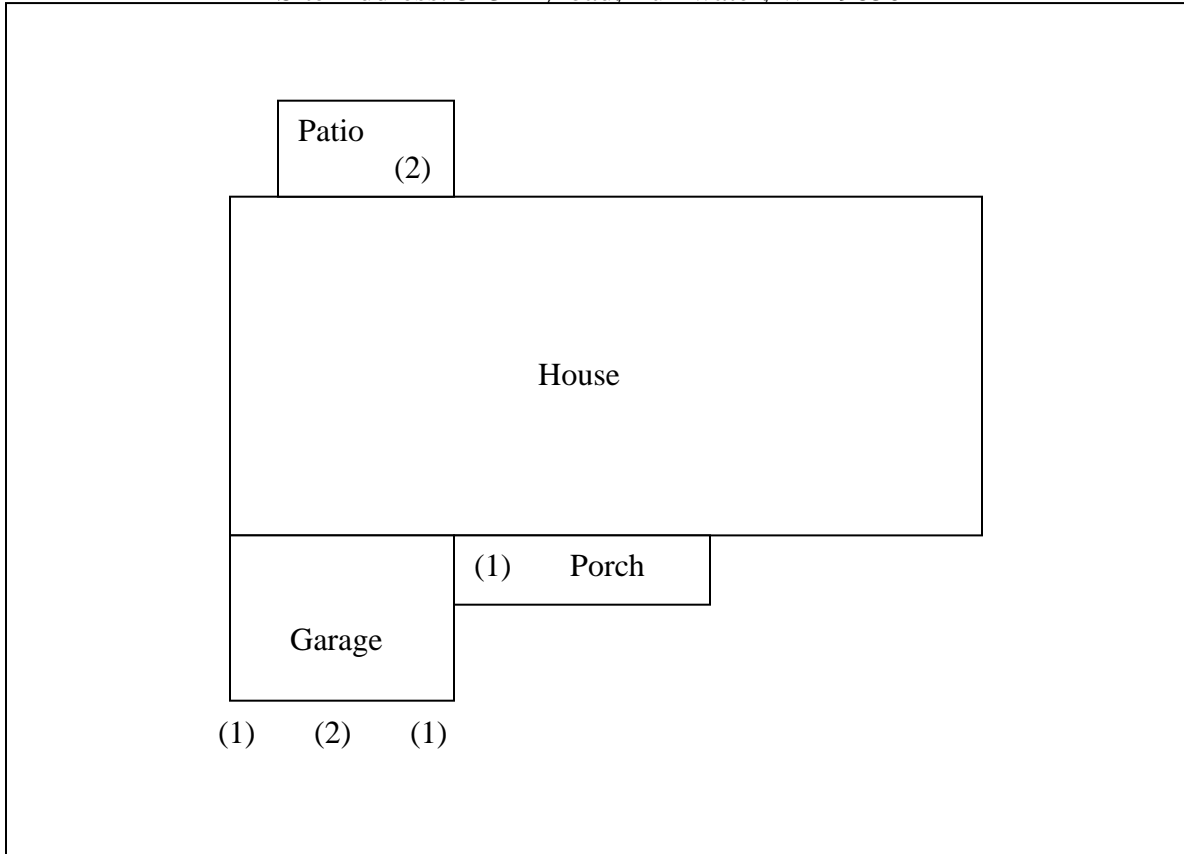

- (1) Three fully shielded light fixtures mounted at both sides of garage and by the front door at a height of 7ft. The fixtures are aimed downwards which prevents light trespass onto neighboring properties and are controlled by motion detectors set on 1 minute timers. No upright is produced by these fixtures. See attachment for picture of light fixture.
- (2) Two fully shielded security floodlights. One mounted at peak of garage roof at a height of 15ft. The other is mounted at the entrance to the back door of the house at a height of 7ft. Both fixtures are shielded and have motion detectors with the timers set at 1 minute. Also, both fixtures are aimed downwards which prevents light trespass onto neighboring properties and prevents upright. See attachment for picture of light fixture.

Statement of Compliance:

This lighting design (including the design, placement, and aiming of the lighting fixtures) complies with the Tumwater outdoor lighting regulations. If it is found that changes are necessary to come into compliance with the regulations the applicant will complete the changes in a timely manner and before an occupancy permit is issued.

Name: _____ Signature: _____

Contact information: _____

Example Basic Lighting Plan p.2 (attachments):

(1) Light fixtures to be used at both sides of garage and at front porch. Full cutoff, dark sky approved, motion detectors.



(2) Light fixtures to be used at the top center of the garage and on the back patio. Fully cutoff with motion detectors. The light will be aimed downwards to prevent glare, uplight, and light trespass.



*Note: Both of these fixtures are available locally.
May 21, 2014*